



Barbara Jean
• COLLECTION •

Linger longer
with Barbara Jean

Linear Outdoor Burner Systems

Unit illustrated is a OB72MVN Linear Burner
(Millivolt/Natural Gas), MQG5C Glass Media
(Bronze x6), MQSTONE Decorative Stones.

Burners

Completely flexible, the Barbara Jean Burner is the perfect project for do-it-yourselfers. Five sizes available (24, 36, 48, 72, 96") and for longer lengths simply link them together to create your own custom size!

Plus, a variety of beautiful log, decorative stone and rock options ensure you create the look you want. When you have achieved your desired look, invite family and friends to gather around for a perfect get together outdoors.

Available in Millivolt, IPI PF2, or Manual Valve systems with HI/LO BTU adjustment.

A

Unit illustrated is a
OB48MVN Linear Burner
(Millivolt/Natural Gas),
MQG5C Glass Media
(Bronze x4), MQSTONE
Decorative Stones.

B

Unit illustrated is a
OB48MVN Linear Burner
(Millivolt/Natural Gas),
MQG5C Glass Media
(Bronze x4), MQSTONE
Decorative Stones,
OB48WG Wind Guard.

B



Linear Outdoor Burner Systems

Certified for USA and Canada: Outdoor Decorative Gas Appliance.

24"	36"	48"	72"	96"
OB24MVN/IPN Natural Gas Millivolt/IPI PF2 40,000 BTU	OB36MVN/IPN Natural Gas Millivolt/IPI PF2 60,000 BTU	OB48MVN/IPN Natural Gas Millivolt/IPI PF2 80,000 BTU	OB72MVN Natural Gas Millivolt Only 120,000 BTU	OB96MVN Natural Gas Millivolt Only 156,000 BTU
Propane Conversion Kit 24OB-CKLP Millivolt 24OB-CKLP2 IPI	Propane Conversion Kit 36OB-CKLP Millivolt 36OB-CKLP2 IPI	Propane Conversion Kit 48OB-CKLP Millivolt 48OB-CKLP2 IPI	Propane Conversion Kit 72OB-CKLP Millivolt	Propane Conversion Kit 96OB-CKLP Millivolt
OB24MAPT* Propane 41,000 BTU Manual Valve w/thermocouple	OB36MAPT* Propane 60,000 BTU Manual Valve w/thermocouple	OB48MAPT* Propane 60,500 BTU Manual Valve w/thermocouple	<i>* Manual Valve Systems (MAPT) are shipped as Propane, NG conversion orifice is included with burner.</i>	
Dimensions (A) x (B) 26"L x 7 1/2"W	Dimensions (A) x (B) 38"L x 7 1/2"W	Dimensions (A) x (B) 50"L x 7 1/2"W	Dimensions (A) x (B) 74"L x 7 1/2"W	Dimensions (A) x (B) 98"L x 7 1/2"W

Glass Media Required

5 lbs per foot of burner (ie: 24" burner = 10 lbs)

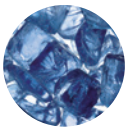

MQG5A
1/2" Cobalt Blue
5 lbs



MQG5W
1/2" White
5 lbs



MQG5C
1/2" Bronze
5 lbs



MQG5B
1/2" Black
5 lbs

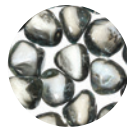

MQG5ZG
Zircon Glacier Ice
5 lbs

Top View



All burners are manufactured with Satin Coat steel with a high temperature black paint finish. Satin Coat steel is pretreated with a Zinc coating for corrosion resistance and paint adhesion.

Side View

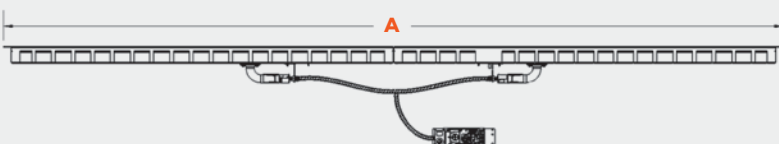

End View

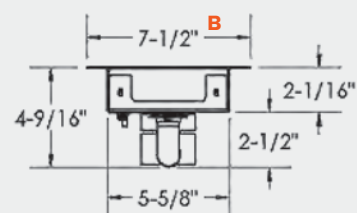

Accessories

The beauty of Barbara Jean Collection is that you can fully customize the look of your unit. Choose convenient accessories and designer options that range from classic driftwood logs to a more contemporary style of ember glass or rocks. Whatever you choose, you'll find the quality and unique style we're certain you'll warm up to.



Standard Accessories



REMOTE CONTROL
(for IPI PF2 models only).
Features flame height modulation and multi-color LED accent lighting control.



Optional Accessories



MQRBD3
Log Set: Driftwood (5 pc)



MQRBD4
Log Set: Driftwood (3 pc)



MQROCK2
Rock Set: Contemporary (Natural)



MQROCK3
Rock Set: Contemporary (Multi-Colored)



RBCB1
Cannonballs: Assorted size and colors (14 pc)



MQSTONE
Decorative Stones (80 pc)



OFP42SA
Spark Assist for Millivolt Valve (AA Battery not included)



OBUVM
Universal Valve Bracket Mount (for Custom Applications)



Wind Guards recommended for Outdoor Burners



OB24WG
for 24" Burners OB24 (4 pc set)

OB36WG
for 36" Burners OB36 (4 pc set)

OB48WG
for 48" Burners OB48 (4 pc set)

OB72WG
for 72" Burners OB72 (4 pc set)

OB96WG
for 96" Burners OB96 (4 pc set)

Wind Guard:
5 1/2"H



Optional PF2 LED Accent Lighting

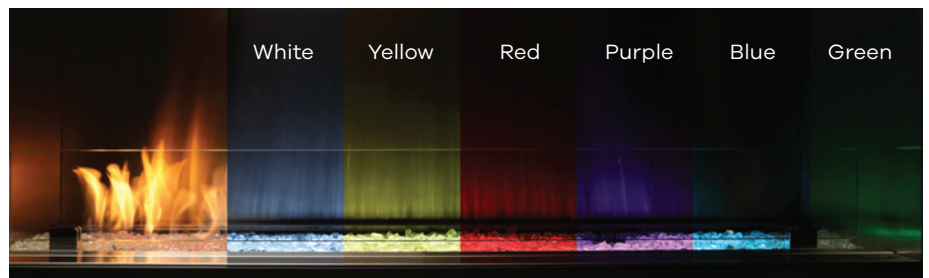

The Barbara Jean Collection maintains a program of continuous testing, refinement and improvements of all its products. Some aspect of units shown here may be changed at any time without notice or obligation.

Certification: Certified for USA and Canada: Outdoor Decorative Gas Appliances.

*Components may have to be ordered separately to create a complete unit. Discuss with your local Dealer for clarification.



FOR CALIFORNIA RESIDENTS ONLY:
WARNING! This product can expose you to chemicals including Carbon Monoxide, that is an externally vented by-product of fuel consumption, which is [are] known to the State of California to cause birth defects or other reproductive harm. For more information, visit www.P65Warnings.ca.gov.



Limited Warranty

Crafted entirely in Canada, each Barbara Jean unit is built to the highest standards and made to last.

Printed in Canada | B0504 | 05/2023

2340 Logan Ave.
Winnipeg, Manitoba
Canada R2R 2V3
Phone: 204.632.1962
Fax: 204.632.1960

BarbaraJeanCollection.com